

**Fitting the brackets**

**1**

The brackets offer two methods of installation:

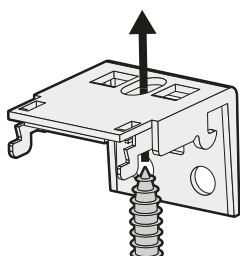

**Top-Fixing**

Use the single hole in the top of the bracket to fix to the lintel (the 'ceiling' of the recess).

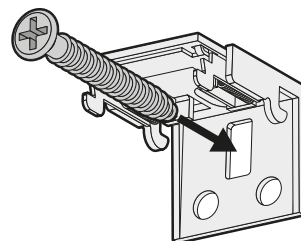

**Face-Fixing**

Screw through the back plate of the bracket to mount onto a facing surface (a wall or window frame).

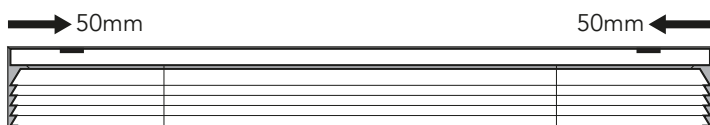

The outermost brackets should be mounted at least 50mm in from the ends of the blind.

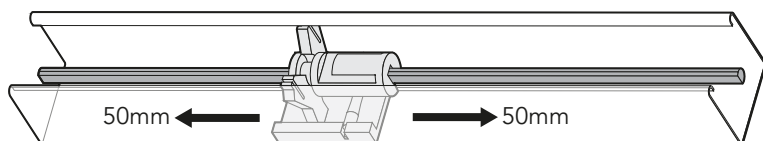

The remainder of the brackets should be spaced evenly along the width of the blind, ensuring that they do not interfere with any of the moving components in the headrail.

**Fitting the blind**

**2**

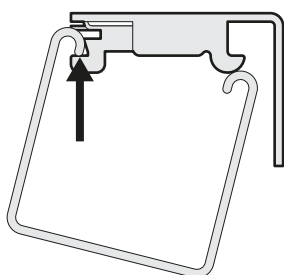

Situate the front lip of the headrail into the front of the bracket.

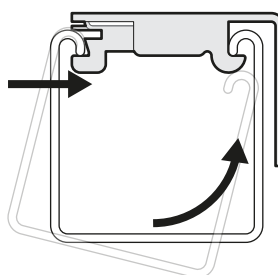

Push the back of the headrail upwards to lock it into the back of the bracket.

**Top Tip**

If you twist the wand to tilt the slats but the slats do not move:

- Make sure the slats are open and flat.
- Stack the blind up tightly and lock it off, then take it down from the brackets.
- Push the metal rod inside the headrail all the way over to the left, so that it is connected to the tilting mechanism.

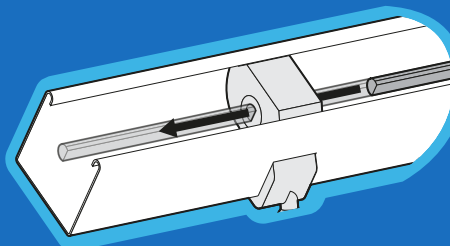

## Child Safety

### Cord Safety Cleat

The safety cleat shall be installed as close to the headrail as possible and **in all cases not less than 1500mm from the floor**. The cord must be fully accumulated around the safety cleat when the blind is not in use.

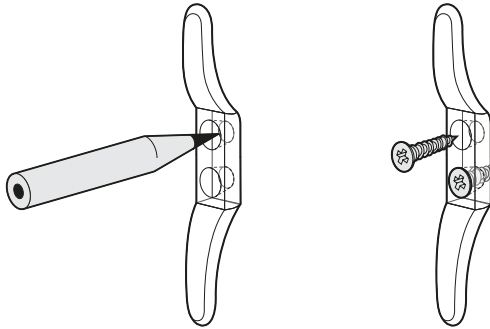

Mark the hole positions and drill as required. Use the screws provided to attach the safety cleat to the wall.

Wrap the cords around the cord cleat in a figure of 8. When the cords are fully accumulated, ensure they are secure so that when any cord is pulled, no excess cord is released.



Young children have died by wrapping loose curtain and blind cords or chains around their necks.



Secure cords or chains with cord guides or keep them out of reach by winding them around a cleat.

Move cots and furniture away from window covering cords or chains.

Do not remove this label.

**WARNING:** To avoid creating a possible strangulation hazard for children, the corded internal window covering must be installed in such a way that a loose cord cannot form a loop 220mm or longer at a height of less than 1600mm above floor level.

## Hold Down Brackets

## Additional Information

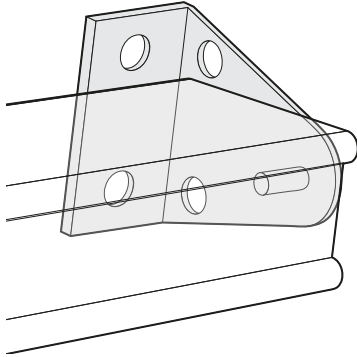

Two triangular, transparent brackets are supplied, which are used to hold the bottom of the blind against the fitting surface. These are only recommended for use when fitting the blind to a door, they are not usually required for window installations.

## Removing the blind from the brackets

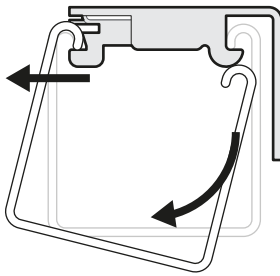

To release the blind from the brackets at any point after installing, push firmly against the blind's headrail to disengage it from the back of the bracket. At the same time, twist the back of the headrail downwards to release it.